

National Centre for Polar & Ocean Research
(An Autonomous Society under the Ministry of Earth Sciences)
Headland Sada, Vasco-da-Gama, Goa-403804



Tender Document

Tender No. : NCPOR/EST/CE/02/22-23

Name of the work : Construction of Antarctic SATCOM Facility at NCPOR, Goa.

Due Date : 12.10.2022 / 11 Hrs.

INSTRUCTIONS TO THE BIDDERS

1. The Director, NCPOR, Goa invites sealed tenders in one cover system, for the work of ‘**Construction of Antarctic SATCOM Facility at NCPOR, Goa**’ on turnkey basis, from the Contractors of Government/PSU/Reputed Organizations. The Eligibility Criteria is as below,

Eligibility Criteria : The bidder should have,

- (a) Executed at least one ‘single civil work’ of Rs.25 lakhs or above OR two ‘single civil works’ of Rs.20 lakhs or above OR three ‘single civil works’ of Rs.15 lakhs or above of any Govt/PSU/reputed organization, company during last seven years ending August 2022. [‘single civil work’ means either single turnkey civil work OR ‘civil AMC work done during one year’s period similar to this tendered work’. AMC means Comprehensive Annual Maintenance Contract with material & labour]. Civil work means Civil Construction work, Painting Work etc. related to this tendered work.

- (b) GST Registration
- (c) PAN/TAN number

- *The bidder should fulfill all above eligibility criteria to become eligible for participating in this tender.*
- *Self attested copies of all above documents should be enclosed. The original documents should be presented for verification as & when asked.*

2. Time period for completion of work is 45days from the date of work order.
3. Any/firm/company which is black listed from any organization &/or facing/having faced any legal/criminal action/case are not eligible for this tender & should not apply.
4. The Earnest Money Deposit (EMD)/Bid Security : It is **Rs. 90,000/--** (Rs. Ninety Thousand only) in the form of a Demand Draft from any schedule bank, drawn in favour of **Director, NCPOR, payable at Vasco-Da-Gama, Goa.**

Pl. Note : Bidders need not to enclose EMD along with the bid document however, bidders should submit undertaking in the format provided at Annexure – IX. Only the successful bidder has to submit the EMD amount as detailed above. EMD of the successful bidder will be converted into Security Deposit.

5. Entire tender document (Signed and Stamped on all pages) should be submitted in a Single Sealed cover (Single BID System), super scribed with Tender number, name of the work, date and time of opening. Tenders will be received up to **11.00 am on 12.10.2022** and will be opened at **11.30 am on the same day**. Tenders should be dropped in the tender box kept in the Estate section before the closing date and time indicated. If the tender opening day happens to be a holiday then tenders will be opened on the next working day on the same time. In case of submission of tender by post/courier, NCPOR is not responsible for any postal/transit delay. Late tenders will be rejected outright.
6. Tender submitted shall remain valid for 90 days from the date of opening for the purpose of acceptance and award of work. The extension of validity beyond 90 days from the date of opening shall be by mutual consent.
7. It is mandatory to quote all items of the price bid. If all items are not quoted then tender will be considered as incomplete & will be rejected outright.

8. NCPOR does not bind to accept the lowest or any tender and reserves the right of accepting the whole or any part of the tender and the tenderer shall be bound to perform as per at the rates quoted.
9. Re-writing, over-writing, use of correction fluid (whitener) is not allowed in the tender. The price bid should neatly handwritten/typed/printed & submitted in original with signature & stamp on all pages. Tender will be rejected if scanned copy or xerox copy is submitted.
10. The Tenderer shall quote rates both in figures and words against each item in English language only. Correction, cutting, omission, should be avoided. However even if any correction is made, it should be endorsed with signature. Use of correction fluid is not allowed & should be strictly avoided. On checking if there are differences noticed between the rates quoted by the tenderer in words and figures or in the amount worked out by him, the following procedure will be followed: (a).If there is a difference between the amount of, rate in figure and in words of an item, and the total amount is worked out, then the rate which corresponds to the amount worked by the bidder shall be taken as correct. (b) If the bidder has not worked out the amount of an item, or the same does not correspond with the rates written either in figures or in words, then the rate quoted by him in words shall be taken as correct. (c) If the rate quoted by the bidder in figures and in words tallies, but the amount is not worked out correctly, the rate quoted by the bidder shall be taken as correct and not the amount.
11. Before submission of tender, interested bidders should inspect the site to acquaint himself about the condition in regard to accessibility of site, nature and extent of ground, working condition of site and locality including stacking of materials, installations of tools and plants etc. required for the satisfactory execution of the work. Accordingly bidders should submit duly signed & stamped 'Tender Submission Letter' (Annexure – VIII) on their Firm's/Company's Letter Head. No claim whatsoever on such account shall be entertained later by NCPOR under any circumstances.
12. Tenders with conditional prices / discounts will be rejected.
13. Successful bidder should commence the work within one week from the date of work order, failure of which the earnest money will be forfeited.
14. Except writing rates and amount, the tenderer should not write any conditions or make any changes, additions, alterations and modifications in the Price Schedule of tender.
15. Defects Liability Period (DLP) : The DLP for the entire work is twelve months from the date of completion of the entire work as certified by the Estate Incharge. If any defect is found in the work during DLP, the Contractor has to rectify the same immediately at his own cost.
16. Security Deposit (SD): EMD of the successful bidder will be converted into SD. It is an interest free deposit which will be released only after successful completion of the Defect Liability Period.
17. Time is essence of the contract. The job must be completed within the stipulated time period, otherwise the contract is liable for penalty &/or termination as stipulated in the penalty clause.
18. A tender is liable for disqualification, if bidder is found to have mislead or furnished false information in the forms / statements / certificates submitted in proof of qualification requirements or record of performance such as abandoning execution of the works, litigation history &/ or financial failures and or suppression of material facts and information .
19. Director, NCPOR reserves the right to accept or reject any or all bids in full or part, or the right to not to accept lowest offer without assigning any reasons thereof, whatsoever. In case of any dispute, decision of Director, NCPOR shall be final and legally binding on the bidders.

-----XXXXXXXXXX-----

STANDARD TERMS AND CONDITIONS OF THE CONTRACT

1. INTERPRETATION:

- a. In construing these conditions the Specifications, the Schedule of Rates, additional Conditions and Agreement, the following words shall have the meanings herein assigned to them except where the subject or context otherwise requires.
- b. The contract shall comprise of the Articles of Agreement, General Conditions of Contract, Additional Conditions, Scope of Work, the Schedule of Rates, Specifications, Drawings, Work Order, Work Order Acceptance and other documents mentioned in the tender.

WORK OR WORKS: shall mean all work or works defined in Schedule of Rates. Specifications, Scope of Work and such other work or works as the Contractor may be entrusted with for carrying out under the contract.

EMPLOYER: shall mean the Director, NCPOR (National Centre for Polar & Ocean Research) or any Officer authorized by the Director for the purpose.

ENGINEER: shall mean the NCPOR Engineer designated by the Employer to superintend and perform other duties as indicated in the contract.

CONTRACTOR: shall mean the individual or Firm or Company, whether incorporated or not, undertaking the work and shall include the legal personal representative or such individual or the persons composing such Firm or Company or the successors of such Firm or Company and the permitted assignees of such individual or Firm or Firms or Company.

SITE: shall mean the site of the contract works including any buildings and erections thereon and any other land adjoining thereto (inclusive) as aforesaid allotted by the Employer or the Engineer for the Contractor's use.

2. CONTRACTOR TO PROVIDE EVERYTHING NECESSARY

- a. The Contractor shall provide at his own cost all materials, (except such materials, if any as may in accordance with the contract, be supplied by the Employer), Plants, tools, appliances, implements, ladders, scaffolding, temporary works etc. requisite for the proper execution of the work whether original, altered or substituted and whether included in the specifications or other documents forming part of the contract or which may be necessary for the purpose of satisfying or complying to the requirements of Engineer, as to any manner as to which under these conditions he is entitled to be satisfied together with carriage therefore to and from the work. The Contractor shall also supply without any extra cost the requisite number of persons with means and materials necessary for the purpose of setting out works and counting, weighing and assisting in the measurement or examination at any time and from time to time of the work or materials. Failing his so doing, the same may be provided by the Engineer at the expense of the Contractor and the expenses may be deducted from any money due to the Contractor under the contract and /or from his Security Deposit.
- b. The Contractor should personally supervise each work till completion or may appoint a qualified Supervisor, pre-approved by the Engineer till the completion of work.
No separate supervision charges will be paid.
- c. NCPOR shall provide requisite quantity of water, electricity for carrying out the work free of cost, subject to availability in the NCPOR campus.
- d. The Employer on no account shall be responsible for the expenses incurred by the Contractor for anything hired, which the Contractor needs to complete the ordered work.

3. DUTIES & TAXES

Rates quoted by the Contractor shall include excise and all duties, octroi, toll tax, levies, royalties and all other taxes in respect of this contract. Goods and Service Tax (GST) as applicable is to be stated specifically in the prescribed columns of the price bid. In absence of any such stipulation, it will be presumed that rates quoted are inclusive GST and no claim whatsoever in this respect will be entertained later.

Bidders may quote the current GST rate in the bid document but for the bid evaluation purpose a uniform GST rate 18% will be considered for all items for all bids. But payment will be made to the Contractor as per the GST quoted by him or as per the prevailing GST rate against submission of documentary evidence.

4. MODE OF PAYMENT

Payment to the Contractor will be made within 30 days upon submission of bill in duplicate after satisfactory completion of the entire work as per the actual quantity executed after deduction of statutory taxes. No part payment / advance will be made. [As per the Govt. of India norms, payment to the Contractors are made online through Public Financial Management System (PFMS). The Contractor should submit his bank & other details in the prescribed format along with the bill.]

5. TESTING OF MATERIALS

The Contractor shall provide assistance, instruments, materials, labour and any other arrangement normally required for testing, checking of materials and workmanship as stipulated in the specifications and by statutory authority at his own cost. The Employer has the right to appoint the testing authorities. The Contractor shall pay for the cost of test samples, its packing, transportation including testing fees. Failing his so doing the same shall be provided by the Engineer at the expense of the Contractor and the expenses may be deducted from any money due to the Contractor under the contract and/or from the Security Deposit or proceeds thereof or of a sufficient portion thereof.

6. **SAFETY & SECURITY** : The Contractor should take utmost care while executing any such work performing at height & make proper adequate safety measures for his workers. Safety & Security of the Contractor's manpower shall be sole responsibility of the Contractor. In case of any accident occurs due to any reasons during the work, NCPOR will not be responsible in any way for it. No extra compensation shall be made to the Contractor and No claim what so ever nature will be given or paid on this account and Contractor is fully responsible for such eventualities and he should indemnify NCPOR from such happening. The Contractor shall provide all safety gadgets to his workers like Full Body Harness, Helmets, Shock resistant Hand Gloves, Safety shoes, Goggles, Masks etc.

7. CONTRACTOR'S ENGINEERS/FOREMAN & WORKMEN

- a. The Contractor shall give all necessary personal superintendence during the execution of the work and as long thereafter as the Engineer may consider necessary until the expiration of the Defects Liability Period. The Contractor shall employ qualified, experienced & competent Site-Engineer/Foreman. Any directions, explanations, instructions or notices given by the NCPOR Engineer to the Contractor's Site-Engineer/Foreman or any other authorized person shall be held to be given to the Contractor.
- b. The Contractor shall on the intimation of the NCPOR Engineer immediately dismiss from the works any person employed thereon who may in the opinion of the Engineer be unsuitable or incompetent or behaved misconduct himself.

7. ACCESS

- a. The Engineer and the Employer or its representative shall at all reasonable time have free access to the works and /or workshops, factories or other places the materials are being prepared or constructed for the contract work and also to any place where the materials are lying or from which they are being obtained and the Contractor shall give every facility to them for inspection. Except the representatives of the Employer or Statutory Authorities, no other person shall be allowed on the works at any time without permission of the Engineer.
- b. If any work is to be done at a place other than the site of works, Contractor shall obtain written permission of the Engineer.

8. VALUATION & PRICE FOR VARIATION

The Engineer with the approval of the Employer shall have power to make any alterations/omissions/additions and /or substitutions from the original specifications, drawings, designs and written instructions and such alterations, omissions, additions, substitutions shall not invalidate the contract and any altered , additional , or substituted work which the Contractor may be directed to do, in the manner specified above as part of the work shall be carried out by the Contractor on the same conditions in all respects on

which he agreed to do the main work. The rates for such altered additional or substituted work under this clause shall be worked out in accordance with the following provisions in their respective order.

- a. If the rates for the altered, additional, or substituted work are specified in the contract for the work the Contractor is bound to carry out the altered additional, or substituted work at the same rates as are specified in the contract.
- b. If the rates for the altered, additional or substituted work are not specifically provided in the contract for the work the rates will be derived from the rates for a similar class of work as are specified in the contract for the work.
- c. Under no circumstances the Contractor shall suspend the work on the plea of non-settlement of rates of items falling under the clause.

9. FAULTY MATERIALS, WORKMANSHIP & DEFECTS AFTER COMPLETION

- a. The Engineer shall have powers to require the removal from the site of all materials and work, which in his opinion are not in accordance with specifications and in case of default, the Engineer shall be at liberty to employ other persons to remove the same without being answerable or accountable for any loss or damage that may happen or arise to such materials to be substituted thereof and in case of default the Engineer may cause the same to be supplied and all costs which may attend such removal and/or substitution are to be borne by the Contractor.
- b. If it shall appear to the Engineer or to the Estate In-charge that any work has been executed with unsound imperfect or unskilful workmanship or with materials of any inferior description or that any materials or articles provided by him for the execution of the work are unsound or of a quality inferior to that contracted for or otherwise not in accordance with the contract any defects, shrinkage or other faults which may appear within the defects liability period of Six months from the date of completion arising in the opinion of the Engineer, the Contractor shall on demand in writing which shall be made within six months of the completion of the work from the Engineer specifying the work, materials, articles defects or other faults complained of notwithstanding that the same may have been passed, certified and paid for forthwith rectify or remove and reconstruct the work so specified in whole or in part as the case may require or as the case may be removed the materials or articles so specified and provide other proper and Suitable materials or articles at his own cost. In case of any such failure, the Engineer may rectify or remove or re-execute the work or remove and replace with others, the material or articles complained of as the case may be at the risk and cost in all respects of the Contractor.
- c. In lieu of rectifying the work not done in accordance with the contract, the Employer may, allow such work to remain, and in that case make allowance for the difference in value, together with such further reduction as in his opinion may be reasonable.
- d. Provided always that nothing in this clause shall relieve the Contractor from his liability to execute the works in all respects in accordance with the terms and conditions of this contract, or from his liability to make good all defects.

10. WORKS TO BE OPEN FOR INSPECTION

- a. All work under or in course of execution or executed in pursuance of the contract shall at all times be open to the inspection and supervision of the Engineer and the Contractor shall at all times during the usual working hours, and at all other times at which reasonable notice of the intention of the Engineer to visit the works shall have been given to the Contractor, either himself be present to receive order and instruction or have a responsible agent duly accredited in writing present for that purpose.
- b. The Contractor shall give not less than seven days notice in writing to the Engineer before covering up or otherwise placing beyond the reach of measurement any work in order that the same may be measured and correct dimensions thereof be taken before the same is so covered up or placed beyond the reach of measurement and shall not cover up and place beyond the reach of measurement, any work without the consent in writing of the Engineer and the Engineer shall within the aforesaid period of seven days inspect the work, and if any work shall be covered up or placed beyond the reach of measurement without such which the same was executed.

11. INDEMNIFYING AGAINST DAMAGES TO PERSONS, PROPERTY & STATUTES

The Contractor shall take all precautions to avoid all accidents by exhibiting necessary caution boards day and night, speed limit boards, red flags, red lights and providing barriers. He shall be

responsible for all damages and accidents caused due to negligence on his part. No hindrance shall be caused to traffic during the execution of work.

- a. The Contractor shall be responsible for all injury to persons, animals or things and for all damage whether such injury or damage arises from carelessness or accident in any way connected therewith. This clause shall be held to include interalia any damage due to causes as aforesaid to work, building(whether immediately adjacent or otherwise) and to roads, streets, footh paths, bridges or ways as well as all damage caused to the buildings and works forming the subject of this contract by inclemency of weather. The Contractor indemnifies the Employer and holds him harmless in respect of all expenses arising from such injury or damages as aforesaid and also in respect of any award of compensation or damage consequent.
- b. The Contractor shall reinstate all damage of every sort mentioned in this clause so as to deliver the whole of the contracted works complete and perfect in every respect and so as to make good and otherwise satisfy all claims for damage as foresaid to the property of third Parties.
- c. The Contractor also indemnifies the Employer against all claim which may be made upon the Employer for acts during the currency of this contract by any employee or representative of an employee of the Contractor or any sub-Contractors, employed by him for any injury to or loss of life of such employees or for compensation payable under any law for the time being in force to any workmen or to the representative of any deceased or incapacitated workmen.
- d. The Employer shall be at liberty and is hereby empowered to deduct the amount of any damages compensation costs charges and /or expenses arising or occurring from or in respect of any such claim and/or damages as aforesaid from any sum or sums due or to become due to the Contractor or security deposit.
- e. The Contractor shall indemnify the Employer against any action claim or proceedings relating to infringement or use of any patent or design or any alleged patent or design rights and shall pay any royalties which may be payable in respect of any article or part thereof included in the contract. In the event of any claims made under or action brought against the Employer in respect of any such matters as aforesaid the Contractor shall be immediately notified thereof and the Contractor shall be at liberty at his own expense to settle any dispute or to conduct any litigation that may arise there from provided that the Contractor shall not be liable to indemnify the Employer if the infringement of the : patent or design of any alleged patent or design right is the direct result of an order passed by the said Employer or his authorized representative .

12. IN CASE OF DEATH OF CONTRACTOR

Without prejudice to any of the rights or remedies under this contract, if the Contractor dies the Employer shall have the option of terminating the contract without any compensation to the Contractor.

13. COMPLIANCE TO LABOUR LAWS

The Contractor shall comply with all the provisions of the Minimum Wages Act, 1948. Contract Labour (Regulation and Abolition) Act, 1970 and rules and orders framed there under and other labour laws affecting contract labour and the rules and orders framed there under that may be in force or brought into force from time to time. NCPOR will not take any responsibilities towards any injury or compensation etc.

14. EXTENSION OF TIME

- a. If the Contractor shall desire an extension of time for the completion of the work on the grounds of his having been unavoidably hindered in its execution or any other ground, he shall apply in writing to the employer within seven days of the date of hindrance on account of which he desires extension as aforesaid and the Employer shall if in his opinion (which shall be final) reasonable grounds shown therefore authorize such extension of time if any which may in his opinion be necessary or proper.
- b. In the event the value of work exceeds the value of the Bill of Quantities owing to variations the Contractor shall be entitled to ask for extension of time in proportion to the increased value of work.

15. VALIDITY OF THE OFFERS: The offers will have to be kept valid for a period of 90 days

from the date of opening of bids. In case of finalization of the tender is likely to be delayed, the tenderer will be asked to extend the same without change in the prices or any terms and conditions of the offer. If any change is made, original or during the extended validity period, the offers will be liable for outright rejection without entering into further correspondence in this regard.

- 16. STATUTORY VARIATION:** Any statutory increase or decrease in the taxes and duties subsequent to suppliers offer if it takes place within the original contractual delivery date will be to the Employers account subject to the claim being supported by documentary evidence. However, if any decrease takes place after the contractual delivery date, the advantage will have to be passed on to the Employer.
- 17. REPEAT ORDERS:** NCPOR reserves the right to issue repeat orders / additional orders to the Contractor up to 25% of the total value of the original Work Order at the same rate, terms and conditions up to One Year from the date of completion of the Original Work.
- 18. PENALTY & TERMINATION OF CONTRACT:** Time is the essence of the contract. If the Contractor fails to maintain the required rate of progress or to complete the work and clear the site on or before the completion date or extended date of completion, he shall without prejudice to any other right or remedy available under the law, pay compensation the amount calculated at the rates stipulated below or as the Employer may decide (whose decision in writing shall be final and binding) on the amount of the tendered value of the work for every completed day / week (as applicable) that the progress remains below or that the work remains incomplete.

In case, the work is delayed/not completed within the period stipulated in the contract, penalty shall be levied @ 0.5% per week of the total contract cost subject to maximum of 10% of the total contract cost. The Engineer may without prejudice to his any other rights or remedy against the Contractor in respect of any delay, inferior workmanship, any claims for damages and / or any other provisions of this contract or otherwise, and whether the state of completion has or has not elapsed, can take decision & inform the Contractor by notice in writing in any of the following cases.

- i. If the Contractor fails to rectify/replace the defects in spite of written notice by Engineer.
- ii. If the Contractor suspends the progress of work so that in the opinion of the Engineer he will be unable to secure completion of the work by the date of completion and do not improve performance even after written notice.
- iii. If the Contractor neglects to carry out his obligation under the contract and / or commits defaults in complying with any of the terms and conditions and does not remedy if even after written notice.

When the Contractor makes himself liable for action under any of the aforesaid cases, fails to complete the work even after six weeks after the completion period or in case the work is found not in accordance with the prescribed specification, drawings, Employer shall exercise its discretionary power either:

- a. To recover, from the Contractor as agreed by way of penalty clause above, OR
- b. To terminate the contract. Upon such termination, the full security deposit recoverable under the contract shall be forfeited/recovered and shall be absolutely at the disposal of the Employer, OR
- c. After giving notice to the Contractor to measure up the work done by him, get the balance work done by another Contractor. Any expenses which may be incurred in excess of the sum which would have been executed by the another Contractor, shall be borne and paid by the original Contractor and may be deducted from any of his dues.

Due consideration will be given for waiver / levy of penalty only for the reasons absolutely beyond Contractor's control for which documentary evidence will have to be provided. The request for extension of time in writing giving reasons for delay with supporting documents shall have to be made immediately.

- 19. POST TENDER CORRESPONDENCE / ENQUIRIES:** Any correspondence or enquiry subsequent to opening of the bids is not desirable, if the same is indulged into, it will be considered for disqualifying the tender. The Tenderer will be required to abstain from pursuing /

canvassing the matter, directly or indirectly with any Officers of NCPOR, as otherwise the same would also amount to disqualification of the tender. However, bidder can ask their queries in writing regarding bidding conditions, bidding process prior to the bid opening and/ or rejection of its bid, reason for rejecting a tender after opening of bids.

- 20. CLARIFICATIONS FROM BIDDERS:** To assist the process of examination, evaluation and comparison of bids, the Employer may ask all the bidders or any bidder individually for clarification, if any, of their bids, including breakdown of unit rates and price. The request for clarification and the response should be in writing, but no change in the price or substance of the bid will be sought, offered or permitted, except as required to confirm the correction of arithmetical errors discovered by the Employer in the course of scrutiny.
- 21. GUARANTEE:** If the goods, stores and equipments found defective due to bad design or workmanship the same should be repaired or replaced by you free of charge if reported within one year from the date of commissioning of items/equipments whichever. The Contractor will be responsible for the proper performance of the equipments / materials for the respective guarantee period.
- 22. SETTLEMENT OF DISPUTES/ARBITRATION:** The decision of the Director, NCPOR shall be final and binding for any dispute whatsoever. All questions, disputes or differences whatsoever which may at any time arise between the parties to this tender contract touching the agreement or subject matter thereof, arising out of or in relation there to and whether as to construction or otherwise shall be referred to the decision of the Sole Arbitrator, appointed by the Director of NCPOR and the decision of the said Arbitrator shall be final and binding upon the parties.
- 23. RIGHT TO CANCEL TENDER/WORK ORDER/CONTRACT :** In case of strike, accident or any other unforeseen conditions causing stoppage of work, NCPOR reserves the right to cancel and/ or modify the tender / work order without any liability for any compensation and / claim or any description.
- 24. FORCE MAJEURE :** If any time, during the continuance of this contract, the performance in whole or in part by either party under obligation as per this contract is prevented or delayed by reasons of any war or hostility, act of the public enemy, civil commotion, sabotage, fire, flood, explosion, epidemic, quarantine restrictions, strike, lockout or acts of God (hereinafter referred to “eventuality”), provided notice of happening of any such eventuality is given by either party to the other within 21 days of the date of occurrence thereof, neither party shall be reason of such an “eventuality” be entitled to terminate this contract nor shall either party have any claim or damages against the other in respect of such non-performance or delay in performance and deliveries under the contract. The contract shall be resumed as soon as practicable after such “eventuality” has come to an end or ceased to exist. In case of any dispute, the decision of Director, NCPOR, shall be final and conclusive, provided further that if the performance in whole or part of any obligation under this contract is prevented or delayed by reason of any such eventuality for a period exceeding 60 days, either party may at its option, terminate the contract. Provided also that if the contract is terminated under this clause the Employer shall be at liberty to take over from the Contractor at a price to be fixed by the Employer, which shall be final, all unused, undamaged and acceptable materials, bought out components and other stores in the course of manufacture which may be in the possession of the Contractor at the time of such termination, or such portion thereof as the Employer may deem fit except such material, as the Contractor may, with the concurrence of the Employer, elect to retain.
- 25. JURISDICTION:** All questions, disputes or differences arising under out of or in connection with the Tender / Contract if concluded shall be subject to the exclusive jurisdiction of the court under whose jurisdiction the place from which the tender / Acceptance of tender is issued, is situated i.e. Goa.

I/ We have read all the Terms and Conditions above carefully and agreed to it.

Name, Signature of the Tenderer with seal:

GENERAL TERMS AND CONDITIONS

1. All materials used shall be as per specifications and ISI marked where ever applicable. ISI marking referred to latest BIS code as published by Bureau of Indian Standards.
2. All measurements shall be at actual and as per site condition. No allowances shall be permitted for rough cast surfaces or for any aesthetical paintings, design bands, etc. Joint measurement shall be recorded with the Engineer.
3. The safe custody and upkeep of various items/equipments/tools & plants of various categories of works brought to site is the sole responsibility of the Contractor and he shall employ sufficient supervisory personnel to ensure the safety of these items.
4. While executing/ assembly of the work the Contractor shall ensure that existing cables/pipe lines/structures/fittings are not damaged and if due to his negligence, these are damaged, the same shall be set right with no extra cost to the employer.
5. The Contractor shall co-ordinate his work with other agencies employed by the employer and ensure that the works of other agencies are not hampered in any way during the duration of the contract.
6. After the work is completed, the Contractor shall clean all the external surroundings, premise etc. to the satisfaction of the Engineer In-charge.
7. Materials shall be brought as supplied by the manufacturer and got approved before being used on the work after inspected and approved by engineer.
8. The tenderer may visit the site and study the work involved vis-à-vis the quantity and specification before submission of bid. If any discrepancy is observed the same should be brought to the notice of the engineer.
9. Contractor shall provide all necessary tools and plants and safety devices etc. to the workmen as required.
10. The Contractor shall submit, at the expense of the Contractor, to the Engineer the material samples and relevant information, for pre-construction review and approval.
12. The Engineer shall make any variation of the form as specified below, be necessary and for that purpose, he shall have the authority to instruct the Contractor to do after taking necessary approval of the Employer and the Contractor shall do any of the following:
 - (a) Increase or decrease the quantity of any work included in the Contract,
 - (b) Omit any such work,
 - (c) Change the character or quality or kind of any such work,
 - (d) Change the levels, lines, position and dimensions of any part of the Works,
 - (e) Execute additional work of any kind necessary for the completion of the Works, or
 - (f) Change any specified sequence or timing of construction of any part of the Works.
13. **Corona Pandemic Precautions** : It is very important that Contractor should ensure that workers, labours deployed by him should not be sick & suffering from any illness. All your workers must use face masks, maintain social distancing, use sanitizer/wash hands & strictly follow guidelines of MoHFW, Govt. of India for COVID pandemic situation.

-----XXXXXXX-----

PARTICULARS OF THE TENDERER

Name of the Contractor : _____

Name of the Firm : _____

Telephone No. (Office) : _____

Telephone No. (Residence) : _____

E-mail ID* / website : _____

(* Email ID should be provided which will be used for official correspondence)

Office Address : _____

: _____

Residential Address : _____

: _____

Mobile No : _____

*PAN /TAN No. of the Firm : _____

*GST Regn. No. : _____

*Shop Act/Trade Licence No. : _____

*Contractor Registration No: _____
(with other Govt. organizations, if any)

Have you ever been black listed from any Company/Organization/Institute etc. : YES / NO

(*pl. enclose true copies)

Name, Signature of the Tenderer with seal:

WORK COMPLETION PROFORMA

Pl. provide work details. Bidder should have executed at least one 'single civil work' of Rs.25 lakhs or above OR two 'single civil works' of Rs.20 lakhs or above OR three 'single civil works' of Rs.15 lakhs or above of any Govt/PSU/reputed organization, company during last seven years ending August 2022.

* Work Orders & Work Completion Certificates should be enclosed.

Sr.	Name of work	Name of the Client and Location of site	Value of work	Date of completion of work	Name of the Contact Person and contact numbers

***Pl. note, Work Order & it's Work Order Completion Certificate together will be considered as a work.**

Signature of the Tenderer with seal

SCOPE OF THE WORK**I. Scope of work :**

1. Foundation work:

- Excavation work for foundation masonry and footing of a depth of 30cm using the necessary tools and equipments.
- Compaction of the surface.
- Rubble soling with hard laterite stone for foundation masonry, footing including watering ramming and consolidating, etc.
- Laying plain cement concrete (P.C.C) (1:3:6) for Foundation masonry, the footing of specified grade up to 100mm thick including ramming and the cost of centering and shuttering.

2. Footing:

- Shuttering of footing base of size 1.2m X 1.2m.
- Reinforcement of 12mm bars at 100mm c/c along both directions.
- Laying of M30 concrete in the footing base of size 1.2m X 1.2m X 0.3m.
- Laying of footing pedestal of size 0.23m X 0.23m X 1.2m with M30 concrete and reinforcement of column as specified by Engineer- In- Charge.
- Step footing of Laterite masonry to be done in the foundation of the size specified by the Engineer in charge.
- The laterite shall be exposed preferably for three months before being used in the construction of masonry. the laterite shall be without any soft veins, cracks, cavities, flaws, and similar imperfections.

3. columns, sill beam, lintel beam, and roof beam Plinth level:

- A plinth beam of size 0.23m X 0.23m should be layed above the foundation masonry with necessary shuttering, reinforcement, and M30 concrete.
- The plinth area is to be filled with soil and has to be well compacted.
- Rubble soling is to be placed above the compacted soil.
- Laying plain cement concrete (P.C.C) (1:3:6) above rubble soling of specified grade up to 100mm thick including ramming and the cost of centering and shuttering.

4. R.C.C:

- Reinforcement for the columns, sill beam, lintel beam, and roof beam is to be done as per the drawings provided by the Engineer in charge.
- Shuttering for the columns, sill beam, lintel beam, and roof beam as per the size mentioned in the drawings.
- Laying of M30 grade concrete for columns, sill beam, lintel beam, and roof beam with proper cover, compaction, etc.

5. Laterite Masonry:

- Laterite masonry is to be done above the plinth as per the layout drawings
- The laterite shall be exposed preferably for three months before being used in the construction of masonry. the laterite shall be without any soft veins, cracks, cavities, flaws, and similar imperfections.
- Laterite masonry in cement mortar 1:5 (1 cement:5 sand) with best quality local laterite with compressive strength not less than 3.5 N/mm² .
- Laterite stone with machine cut finish. The size of the available laterite is to be confirmed and approved before ordering the material.

6. Fabricated roofing structure:

- The main ridge of size 80x40x5mm is to be embedded in the roof beam.
- The rafter of size 60x40x5mm is to be placed along the ridge with a spacing of 600mm.
- The purlins of size 40x40x3 mm are to be placed across with a spacing of 1000mm.
- The PUF roofing panel of 1m in width and 30mm in thickness with a bottom sheet of 0.35mm and a top sheet of 0.4mm.

- The panel is to be fixed with one profile overlap longitudinally and 100mm overlap horizontally and fixed to purlins with stainless steel self-tapping screws of nut bolt arrangement of 100mm long.
- The joints are to be sealed with PU foam sealant with the property of self-expanding and solidifying, to create an impermeable membrane at the location wherever applied.

7. Plastering and finishing:

- Internal walls are to be plastered in 12mm cement plaster.
- In 1 coat under layer 12 mm thick cement plaster 1:4 (1 cement: 4 coarse sand) finished with sand-faced sponge finish at all heights.
- The proportion recommended by the manufacturers per bag of 50 kg of cement used in the mix & as Approved by the Engineer-In-Charge.
- Preparing, Scrapping and cleaning the internal walls for Painting.
- Application of one coat of internal primer.
- Application of Two or more coats with washable emulsion (plastic) paint on Internal walls of approved make, color, and shade to give an even finish, all as directed by the Engineer in charge.
- External walls are to be plastered in 18mm cement plaster.
- In 1 coat under layer 18 mm thick and second coat of 6mm thick cement plaster 1:4 (1 cement: 4 coarse sand) finished with sand faced sponge finish at all heights.
- The proportion recommended by the manufacturers per bag of 50 kg of cement used in the mix & as Approved by the Engineer-In-Charge.
- Preparing, Scrapping and cleaning the External walls for Painting.
- Application of two coats of base coat.
- Application of Two or more coats with top coat premium waterproofing paint having waterproofing and anti-algal warranty of approved make, color, and shade to give an even finish, all as directed by the Engineer in charge.

8. Miscellaneous works;

- Providing and fixing and laying vitrified floor tiles in size 600mmx600mm with water absorption's less than 0.08% and conforming to IS:15622 of approved make in all colors and shades, laid on 20mm thick cement mortar(1:4(1 cement:4 coarse sand) including grouting the joints with white cement and matching pigments, etc. complete.
- Providing and fixing tiled false ceiling of specified materials of size 595x595 mm in true horizontal level, suspended on an interlocking metal grid of hot dipped galvanized steel sections consisting of main "T" from 0.30 mm thick (minimum) sheet, spaced at 1200 mm center to center and cross "T" of size 24x25 mm made of 0.30 mm thick (minimum) sheet, 1200 mm long spaced between main "T" at 600 mm center to center to form a grid of 1200x600 mm and secondary cross "T" of length 600 mm and size 24x25 mm made of 0.30 mm thick (minimum) sheet to be interlocked at the middle of the 1200x600 mm panel to form grids of 600x600 mm and wall angle of size 24x24x0.3 mm and laying false ceiling tiles of approved texture in the grid including, required cutting/making, opening for services like diffusers, grills, light fittings, fixtures, smoke detectors, etc. Main "T" runners to be suspended from the ceiling using GI slotted cleats of size 27 x 37 x 25 x 1.6 mm fixed to the ceiling with 12.5 mm dia and 50 mm long dash fasteners, 4 mm GI adjustable rods with galvanized butterfly level clips of size 85 x 30 x 0.8 mm spaced at 1200 mm center to center along main T, bottom exposed width of 24 mm of all T-sections shall be pre-painted with polyester paint, all complete for all heights as per specifications, drawings and as directed by Engineer-in-charge.
- Providing and fixing the main door with First Class FRP frame and door with sheets of min 1.5mm on both sides of the door glued to the solid wood within with epoxy along with steel butt hinges, SS door handles, door closer, door stopper, lock, etc, and necessary screws included.
- Providing and fixing the Anodised Aluminium door and windows with steel butt hinges, SS door handles, door closer, door stopper, lock, etc, and necessary screws included.

9. **Air Conditioners:** SITC of Energy efficient 1 Ph N,230V,1.5 Tonnes,3 Star Rating & Above, Inverter type Split Air Conditioner(Latest Model), complete with indoor/outdoor unit with all required accessories like copper tubing(100% copper tubing which includes evaporation unit as well as condenser unit) with insulation, R134(Refrigerant supply), drain pipe, supporting brackets for

- indoor/outdoor unit(U type clamping structure to be supplied and used for installation of outdoor assembly fastened by anchor fasteners in separate foundation used for outdoor assembly), external wiring between outdoor and indoor unit, remote control module, with all accessories having LCD, temp. The setting, mode selector, etc., and any other item not specified but required for satisfactory operation. The installation includes the supporting structure, platform tapping of power from the nearby power points with suitable size of XLPE, FRLS cables, Conduit, clamp, Plug top, hardware, etc. The job requires complete installation.
10. **Timer control module:** SITC of 1 Phase, 50 Hz, Surface mounted (with appropriate fixing arrangement) timer control module for changeover operation of air conditioner units alternatively. The timer control module should have a delay time of 2 minutes & 30 sec and change over time delay: 4/8 Hours, Protections: Over voltage (OV): Cutoff 270 V & Cut in 260 V Under voltage (UV): Cutoff 160 V & Cut in 170 V. The job requires complete installation.
 11. **Ceiling fan:** SITC of 240 V AC, 48" sweep, energy efficient ceiling fan (3 Star rating & above) with all other hardware and accessories like a ceiling rose, Junction box, etc. The job also includes fixing the hook by welding/grouting or anchor/Clamping/Anchor fastener as required making good or ceiling after installation by plastering with cement and also providing extra length down rod pipe if required. The job requires complete installation.
 12. **Earthing:** Earthing by providing a special type earth electrode having 76 mm diameter (N.S) copper bonded M.S pipe thickness 3mm,3.0 meter long as a secondary electrode, 25x3 mm thick copper strip of 3m length as primary electrode duly filling with crystalline conductor mixture (ccs)/super quality material filling compound between the primary and secondary electrode and excavation of earth having 100 mm diameter by boring machine inclusive of using super quality material filling compound in the gap between the second electrode and for a good value of earthing and providing masonry enclosure with a cover plate of cast iron. Providing and fixing 25 mm X 5 mm G.I. strip in 25 mm diameter G.I. pipe from earth electrode including connection with G.I. nut, bolt, spring, washer excavation, and re-filling, etc. as required. The procedure recommended by the chemical earth supplier and IS code is to be finally adopted. Item also includes the provision of earth station flags with pit no and date of inspection and the next due date of inspection. The job requires complete installation.
 13. SIT of Modular type lighting ON/OFF switchboard having 16SWG GI sheet metal box modular type, inner and outer module plate with a frame of suitable make. The job requires complete installation.
 14. **Distribution board:** SIT of 415V, 3Ph & N, 50Hz, double door, 12 Way (4+36) TPN Distribution board(VERTICAL type) consisting of painted sheet steel enclosure (IP-43),100A (4P-10KA) RCCB incomer feeder having Cu bus bar, Danger plates, PVC FRLS wire, DIN rail, detachable gland plate, etc. and as per IS/IEC. Minimum thickness of sheet steel shall be a minimum of 1.6 mm & Boards shall be suitable for wall/Surface mounting consisting of the below-mentioned incoming and outgoing feeders. The job requires complete installation Note: Installation of Distribution board to be concealed in the wall & sealing of wall opening after installation.SIT of 4 Way 1 Ph & N, 50Hz, double door, (2+10 Way)Distribution board(horizontal type) consisting of painted sheet steel enclosure (IP-43),2 Incoming 10 outgoing, having Cu bus bar, Danger plates, PVC FRLS wire, DIN rail, detachable gland plate, etc. and as per IS/IE. The minimum thickness of sheet steel shall be a minimum of 1.6 mm & Boards shall be suitable for wall/Surface mounting consisting of the below-mentioned incoming and outgoing feeders. The job requires complete installation
Note: Installation of Distribution board to be concealed in the wall & sealing of wall opening after installation.
 15. **Cables:** SITC of the following sizes cable. The Job also includes Horizontal and Vertical Laying of PVC cables of the following sizes and particulars on cable trenches/floor slits, in PVC conduit (including chipping of floor wherever required), on cable trays, cable racks, cable risers, supports, hangers, saddles, with appropriate gland and termination with suitable lugs, etc. Sealing of wall openings and pipe sleeves after cable laying etc. Including handling, transportation from owner's store/storage yard to the installation site, unpacking, inspection, cable dressing, fixing of cable clamps in vertical and if necessary, proper dressing of cable with Al clamps as well as cable tie at intervals in horizontal as well as vertical runs, fixing of cable identification tags (At every 20 Meter. interval all along the length); testing before and after laying; supply & fixing of Aluminum cable clamps and

- cable tags, GI saddles and GI saddle bars, providing cable route marker for buried cable trenches, GI bolts, nuts, and washer screws, etc. Measurement of IR value, testing of cables before and after terminations for IR values, all work, labor, and materials complete as per drawings, specifications, codes, and standards and directions of Engineer-in-Charge. SIT of PVC rigid conduit of various sizes as mentioned in the BOQ with bends, reducers, couplers, etc. at the proper interval and places. The job requires complete installation.
16. **Lightning arrester:** SITC of 1000mm long, 20 mm dia. Hot dipped GI air termination rod (lightning rod-120 Micron coating) with all fixing material, and accessories as per IS:2309. The job requires complete installation.
 17. **Rubber mat:** 11KV, 900 mm wide, electric grade floor rubber mat (in pieces of length not less than 2 meters.) ISI marked. The job requires complete installation.
 18. **Fire extinguishers:** SIT of Fire extinguishers CO2 type in 4.5kg capacity as per IS 2878/UL 154 complete with handle, fixing bracket, etc. The job requires complete installation.
 19. **Cable tray:** Supply and installation of GI Perforated Cable tray 300 mm Wide 50 mm deep 1.6+ mm thick with minimum hot dip zinc coating 100 microns with accessories like coupler plates, bends, Stainless steels hardware like nuts & bolts, bends, washers, etc. The job also includes fixing of cable tray by welding/grouting or anchor fastener as required making good of ceiling after installation by plastering with cement and painting of walls. The job requires complete installation.
 20. **Dehumidifier:** SITC of wall-mounted 1-Phase, 50 Hz dehumidifier with a dehumidifying capacity of 20L/day. The job requires complete installation.
 21. **GLS bulkhead lights:** SITC of GLS Bulkhead light for the outside periphery of Antarctic SATCOM Facility including bracket, clamping arrangement, and all other accessories for complete installation. The job requires complete installation.
1. All materials shall be designed and manufactured as the latest statutory rules, CEA guidelines, and IS/IEC. All works shall be carried out as per the latest statutory rules, CEA guidelines, Indian standards, and other applicable rules, regulations, and guidelines.
 2. The contractor shall submit and secure approval from NCPOR for all vendor's data sheets/specification sheets/ drawings for the items being procured by them. Supplier shall obtain clearance from NCPOR before taking procurement action of various electrical items required for complete Electrical work. Review and approval of drawings/documents and consequent changes during review/approval shall not have any price and time implications.
 3. Supply and installation of all hardware and other materials as per the requirement of the work.
 4. All civil jobs like chipping, breaker of the floor, wall, column, sealing of openings, etc. with all required materials, manpower, tools, tackles, etc. complete for carrying out the entire electrical works shall be in the contractor's scope.
 5. Site mobilization including making own arrangements for construction power as well as power for other purposes, water, resource mobilization, setting up of the office, stores, workshop, etc. shall be in the contractor's scope. All required vehicles for the transportation of materials shall be in the contractor's scope.
 6. The handling, transportation of equipment/materials/items to site for erection, safe keeping of equipment and installation till completion of entire works, submission of drawings and documents, etc. shall be in the Contractor's scope.
 7. The site shall be cleared of excess and left-over equipment and materials, procured and supplied by the contractor but not used in his work.
 8. Contractor to deploy adequate experienced manpower for timely and satisfactory completion of the project right from the beginning till handing off the project. All safety measures as prescribed by NCPOR shall be strictly followed by the contractor. Supply of all required safety materials, Tools and tackles, etc. shall be within the contractor's scope.

9. Testing kits, tools, tackles, hardware, etc., and monitoring/measuring instruments are required for various equipment/items during installation, testing & commissioning. All testing equipment shall be duly calibrated.
10. All related operations, troubleshooting, and maintenance manuals for the system/Equipment along with drawings, test certificates, and warranty certificates for each piece of equipment are to be submitted before execution or along with the supply of equipment.
11. Preparation of all required design drawings/documents for carrying out the complete works shall be in the contractor's scope including preparation and submission of hard copy and soft copy of as-built drawings, BOQ, and revised/final documents. The contractor is to prepare site test reports of the items and the same shall be submitted to NCPOR.
12. Make of all equipment and components shall be strict as per approved make attached list if any other item not listed will be subject to NCPOR Approval. Supply and installation of all other equipment/accessories not specifically mentioned herein but necessary for the completion of the job.
13. Statutory approval for complete works and consequent changes/modifications as recommended shall also be in the contractor's scope.
14. Wiring for lighting fixtures, fans by using 1cx1.5 Sq mm (Phase and neutral), & 1.5 Sq mm (Earthing) & modular switchboard and power sockets using 1cx2.5 Sq mm (Phase and neutral), & 2.5 Sq mm (Earthing) Complete wiring should be carried out through 25 mm PVC conduit concealed in walls/ceiling, surface conduit above the false ceiling. Circuit wiring for 16 A Switch sockets for Air conditioner units shall be done through 3cx4 Sq mm Cu cable. Complete wiring should be carried out through 25 mm or 50 mm PVC Rigid conduit concealed in walls/ceiling, or surface conduit above false ceiling with all PVC accessories. wiring for the server unit shall be done through 3cx6 Sq mm Cu cable with 32 mm PVC Conduit.

II. List of recommended makes and IS standards to be followed :

- **Waterproofing materials (Bonding agent):** Fosroc Nitobond EP / Dr. fixit Epoxy bonding Agent / any other equivalent product.
- **Warranty based Exterior Waterproof Acrylic Paint:** Asian paints-Apex Ultima Protek Duralife with 10 years manufactures warranty/ any other equivalent brand and its corresponding equivalent product.
- **Interior washable Emulsion Paint:** Asian paints- Apcolite Premium Emulsion / Berger-Easy clean Luxury emulsion / Rangoli Total Care Nerolac / any other equivalent product.
- **Epoxy Paint:** Asian paints-Apcolite Advance 2-pack Epoxy finish – Equivalent product as above.
- **Zinc Chromate Primer:** Asian Paints / Fosroc / Dr.fixit / Equivalent Primer.
- **Wall care putty:** Asian Paints -Acrylic Wall Putty / Berger- Bision Wall Putty / Nerolac- Equivalent product as above.
- **Crack filler-** Asian Paints– Smart care Seal / Berger – Home Shield / Nerolac / Sika / Equivalent Product as above.
- **Cement:** ACC / Ultratech / Ambuja cement (OPC 43 grade cement) / any other equivalent product.
- **Laterite:** Best available local material fulfilling IS Specifications
- **Sand:** Best available local material fulfilling IS Specifications.
- **Coarse aggregate:** best available local material fulfilling IS Specification.
- **Fine aggregate:** best available local material fulfilling IS Specification.
- **Laterite Rubble:** best available local material fulfilling IS Specification
- **Reinforcement:** TMT Steel reinforcement conforming TO IS 1786 of 1985 : Tisco / Sail / Rinl / Goa Ispat / Essar / Tata / any other equivalent product.
- **M.S Tube:** Jindal / Tata / Apollo / any other equivalent product.
- **PUF Roofing Panel:** JSW / any other equivalent product.
- **Vitrified tiles:** Kajaria / Nitco/ Simpolo / any other equivalent product.

- **False ceiling:** Saint-Gobain / Armstrong / any other equivalent product.
- **FRP doors:** Best available local material fulfilling IS Specifications.
- **Aluminium sections:** Best available local material fulfilling IS Specifications.
- **PVC Lighting Wires:** Finolex/ Havells/ Polycab/Anchor / any other equivalent product.
- **Main Distribution Board & MCB:** Havells / L & T /Siemens /Schnider/ ABB/ any other equivalent product.
- **MCCB/ RCCB/ Isolator:** Havells / L & T /Siemens /Schnider/ ABB/ any other equivalent product.
- **PVC Conduits/ Casing:** Supreme/Finolex/Astral/Ashirvad / any other equivalent product.
- **Modular Switches & Switch Board:** Anchor / Havells/ Schnider/ Legrand / any other equivalent product.
- **Office Light Fittings/GLS Bulkhead lights:** Philips/ Wipro/ Crompton Greaves/ Bajaj / any other equivalent product.
- **Ceiling / Pedestal Fans:** Crompton Greaves/Usha /Havells /Orient /any other equivalent product.
- **Air Conditioner Unit:** Voltas/Carrier/Bluestar etc.
- **Dehumidifiers:** Frigidaire/Honeywell/LG/GE/OC/any other equivalent product.
- **Timer switch for AC:** Proton/L&T/Siemens/L&T /any other equivalent product.
- **Cable Tray:** Hutaib/Parmar Industries/Bravo Industries /any other equivalent product.
- **Fire Extinguishers:** Safex/Kanex/Ultra fire/Relish fire /any other equivalent product.
- **Rubber Mat:** Vardhaman Electrical/Deep-Jyoti/Laxmi Rubber/Jyoti Rubber /any other equivalent product.
- **Earthing:** Ashlok Industries/Ashoka/SBS Power/Power Gem /any other equivalent product.

** In the event of non- availability of the recommended brands, suitable substitution may be made with a prior approval.*

III. IS standards :

The following IS standards are to be followed while executing the project:

- IS 3764: Code of safety for excavation work.
- IS 1597 (Part 1) : 1992 construction of stone masonry code of practice.
- IS: 456: Plain and reinforced concrete.
- IS: 1161: Steel tube for structural purposes.
- IS: 2402-196: Code of practice for external rendered finishes.
- IS: 5411(part 1 & part 2): Paint, Plastic Emulsion.
- IS: 383: coarse and Fine aggregate for concrete.
- IS: 432: mild steel and medium tensile steel bars and hard-drawn steel wire for concrete reinforcement.
- IS: 1239: steel tubes, tubular and other wrought steel fittings.
- IS: 12701: Rotational molded polyethylene water storage tanks.
- IS 1443: Code of practice for laying and finishing of cement concrete flooring tiles.
- IS ; 2441- 1984: Code of practice for fixing ceiling coverings.
- IS: 816: metal arc welding for general construction in mild steel.
- IS: 3620-1979: Specification for laterite stone block for masonry.
- IS732:1989: Code of practice for electrical wiring installations (third revision).
- IS4648:1968: Guide for electrical layout in residential buildings.
- IS3646 (Part 1):1992: Code of practice for interior illumination: Part 1 General requirements and recommendations for working interiors (first revision).
- IS374:1979: Electric ceiling type fans and regulators (third revision).
- IS 9537 (Part 1): Conduits for electrical installations: Part 1 General Requirements.
- IS10322 (Part5/Sec.2):2012: Luminaires: Part5 Particular requirements, Sec 2 Recessed luminaires (First Revision).
- IS3043:1987: Code of practice for earthing.
- IS 5216 (Part1):1982: Recommendations on safety procedures and practices in electrical work: Part 1 General (first revision).
- IS2309:1989: Code of practice for protection of buildings and allied structures against lightning (second revision).

SCHEDULE OF RATES (PRICE BID)**Annexure – VII***(Only RATE in words and figures. Amount in figures)*

ITEM NO	DESCRIPTION	UNIT	QTY	RATE (Rs.)	AMOUNT (Rs.)
(A)	(B)	(C)	(D)	(E)	(F)
1	Earthwork in surface excavation not exceeding 30 cm in depth but exceeding 1.5 m in width as well as 10 sqm on plan including getting out and disposal of excavated earth upto 50 m and lift upto 1.5 m.	sqm	88.21		
<i>Only rate(E) in words</i>					
2	Rubble soling with hard laterite stone under floors including watering ramming and consolidating etc in foundation complete.	sqm	189.97		
<i>Only rate(E) in words</i>					
3	Providing and laying in plain cement concrete(1:3:6) of specified grade up to 100mm thick including ramming and the cost of centering and shuttering.	cum	19.00		
<i>Only rate(E) in words</i>					
4	Providing & Laying cement concrete of M30 with a design mix of cement content of 360 kg/m ³ (OPC-43), water of 144kg/m ³ , graded granitic or basaltic stone aggregate 20mm downward nominal size 661kg/m ³ & 10mm stone aggregate of 479kg/m ³ , coarse sand of 807kg/m ³ , Admixture of 2.95kg/m ³ including the cost of reinforcement(as mentioned in drawings), centering, shuttering & levels including waterproofing compound in the proportion recommended by the manufactures per bag of 50 kg of cement used in mix.	cum	13.4		
<i>Only rate(E) in words</i>					
5	Laterite masonry in cement mortar 1:5 (1 cement :5 sand) with best quality local laterite with compressive strength not less than 3.5 N/mm ² . Laterite stone with machine cut finish. The size of the available laterite to be confirmed and approved before ordering the material.	cum	52.29		
<i>Only rate(E) in words</i>					
6	Plastering the internal walls in 12mm cement plaster in 1 coat under layer 12 mm thick cement plaster 1:4 (1 cement: 4 coarse sand) finished with sand faced sponge finish at all heights the proportion recommended by the manufacturers per bag of 50 kg of cement used in mix & as Approved by the Engineer-In-Charge.	sqm	144.157		
<i>Only rate(E) in words</i>					
7	Plastering the External walls in 18mm cement plaster in 2 coats under layer 12 mm thick cement plaster 1:3.5 (1 cement: 3.5 coarse sand) and top layer 6 mm thick. With cement plaster 1:2.5 (1 cement: 2.5 coarse sand) finished with sand-faced sponge finish at all heights the proportion recommended by the manufacturers per bag of 50 kg of cement used in mix & as Approved by the Engineer-In-Charge.	sqm	143.007		
<i>Only rate(E) in words</i>					

8	External Painting (Three or more coats on old work) with Waterproof Acrylic emulsion paint on external wall applying a coat of primer of approved make, color, and shade to give an even finish, all as directed including scrapping, cleaning, and all materials, labor, scaffoldings, brushes, tools, equipment, etc., complete. Note: The above painting should be inclusive of the base coat (primer cum waterproofing coat-two nos)and top coat (Paint coat-two nos). This should be premium waterproofing paint having waterproofing and anti - algal warranty. Refer to recommended makes and warranty terms for details.	sqm	144.2		
<i>Only rate(E) in words</i>					
9	Internal Painting (Two or more coats) with washable emulsion (plastic) paint on Internal walls over a coat of applied primer of approved make, color, and shade to give an even finish, all as directed including scrapping, Cleaning, and all materials, labor, scaffoldings, brushes, tools, equipment, etc., complete.	sqm	143.0		
<i>Only rate(E) in words</i>					
10	Preparing and painting the structural steel members by scrapping and removing rust, applying one coat of zinc chromate primer and two coats of good quality Epoxy Colour paint of approved make, color, and shade to give an even finish, all as directed at the site including all labor, materials, brushes, tools, equipment, etc., complete.	sqm	35.59		
<i>Only rate(E) in words</i>					
11	Providing and fixing PUF roofing panel of 1m width 30mm thickness with bottom sheet of 0.35mm and top sheet of 0.4mm. The panel to be fixed with one profile overlap longitudinally and 100mm overlap at horizontally and fixed to purlins with stainless steel self-taping screws of nut bolt arrangement of 100mm long and the joints to be sealed with PU foam sealant with property of self expanding and solidifying, to create an impermeable membrane at the location wherever applied.	sqm	102.1		
<i>Only rate(E) in words</i>					
12	Providing and fixing and laying vitrified floor tiles in size 600mmx600mm (thickness to be specified by the manufacturer) with water absorption's less than 0.08% and conforming to IS:15622 of approved make in all colors and shades, laid on 20mm thick cement mortar(1:4(1 cement:4 coarse sand) including grouting the joints with white cement and matching pigments, etc. complete	sqm	63.26		
<i>Only rate(E) in words</i>					

13	Providing and fixing tiled false ceiling of specified materials of size 595x595 mm in true horizontal level, suspended on an interlocking metal grid of hot dipped galvanized steel sections consisting of main "T" from 0.30 mm thick (minimum) sheet, spaced at 1200 mm center to center and cross "T" of size 24x25 mm made of 0.30 mm thick (minimum) sheet, 1200 mm long spaced between main "T" at 600 mm center to center to form a grid of 1200x600 mm and secondary cross "T" of length 600 mm and size 24x25 mm made of 0.30 mm thick (minimum) sheet to be interlocked at the middle of the 1200x600 mm panel to form grids of 600x600 mm and wall angle of size 24x24x0.3 mm and laying false ceiling tiles of approved texture in the grid including, required cutting/making, opening for services like diffusers, grills, light fittings, fixtures, smoke detectors, etc. Main "T" runners to be suspended from the ceiling using GI slotted cleats of size 27 x 37 x 25 x 1.6 mm fixed to the ceiling with 12.5 mm dia and 50 mm long dash fasteners, 4 mm GI adjustable rods with galvanized butterfly level clips of size 85 x30 x 0.8 mm spaced at 1200 mm center to center along main T, bottom exposed width of 24 mm of all T-sections shall be pre-painted with polyester paint, all complete for all heights as per specifications, drawings and as directed by Engineer-in-charge	sqm	57.56		
<i>Only rate(E) in words</i>					
14	Steelwork welded in built-up sections/ framed work in Tubular sections - cutting, hoisting, fixing in position, as per approved drawing and Specification completed in all respect as directed by Engineer-in-Charge.	kg	952.7		
<i>Only rate(E) in words</i>					
15	Providing and fixing of First Class FRP frame and door with sheets of min 1.5mm on both sides of the door glued to the solid wood within with epoxy along with steel butt hinges, SS door handles, door closer, door stopper, lock, etc, and necessary screws included.	sqm	2.90		
<i>Only rate(E) in words</i>					
16	Providing and fixing Anodised aluminium work for doors, windows with extruded built up standard tubular sections/ appropriate Z sections and other sections of approved make conforming to IS: 733 and IS: 1285, fixing with dash fasteners of required dia and size, including necessary filling up the gaps at junctions, i.e. at top, bottom and sides with required EPDM rubber/ neoprene gasket etc. Aluminium sections shall be smooth, rust free, straight, mitred and jointed mechanically wherever required including cleat angle, Aluminium snap beading for glazing / paneling, sealing joints with clear silicon sealant, C.P. brass / stainless steel screws, door handles, door lock, z-hinges, door closer, door stopper, glass, glass filming etc, all complete as per architectural drawings and the directions of Engineer-in-charge.	kg	128.34		
<i>Only rate(E) in words</i>					

17	Supply, Installation, Testing & Commissioning of Energy efficient 1 Ph N, 230V, 1.5 Tones, 3 Star Rating & Above, Inverter type Split Air Conditioner(Latest Model), complete with indoor/outdoor unit with all required accessories like copper tubing (100% copper tubing which includes evaporation unit as well as as condenser unit) with insulation, R134(Refrigerant supply), drain pipe, supporting brackets for indoor/outdoor unit (U type clamping structure to be supplied and used for installation of outdoor assembly fastened by anchor fasteners in separate foundation used for outdoor assembly), external wiring between outdoor and indoor unit, remote control module, with all accessories having LCD display, temp. Setting, mode selector etc. and any other item not specified but required for satisfactory operation. The installation Includes the supporting structure, platform tapping of power from the near by power points with suitable size of XLPE, FRLS cables, Conduit, clamp, Plug top, hardware etc.	Nos	5		
<i>Only rate(E) in words</i>					
18	Supply, Installation, Testing & Commissioning of 1 Phase, 50 Hz, Surface mounted (with appropriate fixing arrangement) timer control module for changeover operation of air conditioner units alternatively. The timer control module should have on delay time of 2 minute & 30 sec and Change over time delay: 4/8 Hr, Protections: Over voltage (OV): Cutoff 270 V & Cut in 260 V Under voltage (UV): Cutoff 160 V & Cut in 170 V.	Nos	2		
<i>Only rate(E) in words</i>					
19	Supply, Installation, Testing of 240 AC, 48" sweep, energy efficient ceiling fan (3 Star rating & above) with all other hardware and accessories like ceiling rose, Junction box etc.The job also includes fixing of hook by welding/grouting or anchor/Clamping/Anchor fastener as required making good or ceiling after installation by plastering with cement and also providing extra length down rod pipe if required.	Nos	1		
<i>Only rate(E) in words</i>					
20	Supply, Installation, Testing of 240V AC, 1x12W LED of size 2'X2', recess mounting (Suitble for false Ceiling) decorative type lighting fixture with integral control gear box, tube, lugs, harwares and all other accessories.	Nos	12		
<i>Only rate(E) in words</i>					

21	Earthing by providing special type earth electrode having 76 mm dia (N.S) copper bonded M.S pipe thickness 3mm, 3.0 meter long as secondary electrode, 25x3 mm thick copper strip of 3m length as primary electrode duly filling with crystalline conductor mixture (ccs)/super quality material filling compound between primary and secondary electrode and excavation of earth having 100 mm dia by boring machine inclusive of using super quality material filling compound in gap between secondary electrode and for good value of earthing and providing masonry enclosure with cover plate of cast iron. Providing and fixing 25 mm X 5 mm G.I. strip in 25 mm dia G.I. pipe from earth electrode including connection with G.I. nut, bolt, spring, washer excavation and re-filling etc. as required. Procedure recommended by chemical earth supplier and IS code to be finally adopted. Item also includes provision of earth station flags with pit nos and date of inspection and the next due date of inspection.	Nos	3		
<i>Only rate(E) in words</i>					
22	Supply, Installation, Testing & Commissioning of Modular type lighting ON/OFF switch board having 16SWG GI sheet metal box modular type, inner and outer module plate with frame of suitable make having the following items: 4 switches of 6A rating for tube lights and 1 nos switch socket with switch of 6A Capacity (Note : Out of 3 Nos board,1 board must contain one no fan regulator in Operator room)	Nos	3		
<i>Only rate(E) in words</i>					
23	Supply & Installation of Modular type 16A, 240 Volt AC, 1ph switch socket with switch and all other accessories required for fittings like sheet metal box, frames etc.	Nos	18		
<i>Only rate(E) in words</i>					
24	Supply, Installation, Testing & Commissioning of 415V, 3Ph & N, 50Hz, double door, 12 Way (4+36) TPN Distribution board (VERTICAL type) consisting of painted sheet steel enclosure (IP-43), having Cu bus bar, Danger plates, PVC FRLS wire, DIN rail, detachable gland plate etc and as per IS/IEC . Minimum thickness of sheet steel shall be minimum 1.6 mm & Boards shall be suitable for wall/Surface mounting consisting of the following below mentioned incoming and outgoing feeders. Note: Installation of Distribution board to be concealed in the wall & sealing of wall opening after installation	Nos	1		
<i>Only rate(E) in words</i>					
a	63A (4P-10KA) RCCB for Mains Incommer	Nos	1		
<i>Only rate(E) in words</i>					
b	32 A Dual pole MCB for Air conditioner units	Nos	5		
<i>Only rate(E) in words</i>					
c	16 A Single pole MCB for switch board unit	Nos	3		

<i>Only rate(E) in words</i>					
d	16 A Single pole MCB for power sockets	Nos	3		
<i>Only rate(E) in words</i>					
e	16 A Single pole MCB for GSL Fittings outside periphery	Nos	3		
<i>Only rate(E) in words</i>					
25	Supply, Installation, Testing & Commissioning of 3 Ph & N, 50Hz, double door, (4+12 Way) Distribution board (horizontal type) consisting of painted sheet steel enclosure (IP-43), 2 Incoming 10 outgoing, having Cu bus bar, Danger plates, PVC FRLS wire, DIN rail, detachable gland plate etc and as per IS/IEC . Minimum thickness of sheet steel shall be minimum 1.6 mm & Boards shall be suitable for wall/Surface mounting consisting of the following below mentioned incoming and outgoing feeders. Note: Installation of Distribution board to be concealed in the wall & sealing of wall opening after installation.	Nos	1		
<i>Only rate(E) in words</i>					
a	16 A Single pole MCB for UPS Power sockets	Nos	4		
<i>Only rate(E) in words</i>					
b	32 A four pole RCCB for UPS input power	Nos	1		
<i>Only rate(E) in words</i>					
c	32 A four pole MCB for Server	Nos	1		
<i>Only rate(E) in words</i>					
26	Supply, Installation, Testing & Commissioning of the following sizes cable. The Job also includes Horizontal and Vertical Laying of PVC cables of following sizes and particulars on cable trenches/floor slits, in PVC conduit (including chipping of floor wherever required), on cable trays, cable racks, cable risers, supports, hangers, saddles, with appropriate gland and termination with suitable lugs etc. Sealing of wall openings and pipe sleeves after cable laying etc Including handling, transportation from owner's store/storage yard to installation site, unpacking, inspection, cable dressing, fixing of cable clamps in vertical and if necessary, proper dressing of cable with Al clamps as well as cable tie at intervals in horizontal as well as vertical runs, fixing of cable identification tags (At every 20m. interval all along the length); testing before and after laying; supply & fixing of Aluminum cable clamps and cable tags, GI saddles and GI saddle bars, providing cable route marker for buried cable trenches, GI bolts, nuts and washer screws etc. Measurement of IR value, testing of cables before and after terminations for IR values, all work, labour and materials complete as per drawings, specifications, codes and standards and directions of Engineer-in-Charge				
a	1C x 1.5 Sq mm (Cu), 1.1 KV grade, PVC stranded, flexible cable/ wire.	rmt	234		
<i>Only rate(E) in words</i>					

b	1C x 2.5 Sq mm(Cu),1.1 KV grade, PVC , stranded, flexible cable/ wire .	rmt	444		
<i>Only rate(E) in words</i>					
c	3CX4sq. mm (Cu), 1.1 KV grade, PVC, stranded, flexible cable/ wire.	rmt	40		
<i>Only rate(E) in words</i>					
d	4CX 6 sq. mm (Cu), 1.1 KV grade, PVC, stranded, flexible cable/ wire.	rmt	20		
<i>Only rate(E) in words</i>					
e	4CX16sq. mm (Al), 1.1 KV grade, Armored Cable.	rmt	85		
<i>Only rate(E) in words</i>					
27	Supply of PVC rigid conduit of min. 2mm thick of wall heavy duty type as per IS (with bends, reducers, couplers etc.) of following sizes:-				
a	25 mm Dia. Heavy duty Rigid PVC Conduit of minimum 2.0 mm thick of wall.	rmt	200		
<i>Only rate(E) in words</i>					
b	32mm Dia. Heavy duty Rigid PVC Conduit of minimum 2.0 mm thick of wall.	rmt	30		
<i>Only rate(E) in words</i>					
28	Supply & Installation of 1000mm long,20 mm dia. Hot dipped GI air termination rod(lightning rod-120 Micron coating) with all fixing material, accessories as per IS:2309	Nos	1		
<i>Only rate(E) in words</i>					
29	11KV, 900 mm wide, electric grade floor rubber mat (in pieces of length not less than 2 m) ISI marked.	Nos	3		
<i>Only rate(E) in words</i>					
30	Fire extinguishers CO2 type in 4.5kg capacity as per IS 2878/UL 154 complete with handle, fixing bracket etc.	Nos	2		
<i>Only rate(E) in words</i>					
31	Supply and installation of GI Perforated Cable tray 300 mm Wide 50 mm deep 1.6mm thick with minimum hot dip zinc coating 100 micron with accessories like coupler plates, bends, Stainless steels hardware like nuts & bolts , bends, washers etc. The job also includes fixing of cable tray by welding/grouting or anchor fastener as required making good of ceiling after installation by plastering with cement and painting of walls.	rmt	20		
<i>Only rate(E) in words</i>					
32	Supply, Installation, Testing & Commissioning of wall mounted 1-Phase, 50 Hz dehumidifiers with dehumidifying capacity of 20L/day.	Nos	1		
<i>Only rate(E) in words</i>					

33	Supply, Installation, Testing and Commissioning of 100W GLS Bulkhead light for outside periphery of Antarctic Satcom Facility including bracket, clamping arrangement and all other accessories for complete installation	Nos	5		
<i>Only rate(E) in words</i>					
Sub Total :					
GST% :					
Grand Total					

Grand Total: Rs. _____

Grand Total in words: Rs. _____

Pl. note :

- Re-writing, use of whitener is not allowed. The price bid should neatly handwritten/typed/printed & submitted in original with signature & stamp on all pages. Tender will be rejected if scanned copy or xerox copy is submitted.
- Discount offered if any, should be included in the quoted rates & should not be shown separately.
- Bidder should quote all items given in the price bid. Tender will be rejected if all items are not quoted.
- Price Evaluation Criteria - The Lowest Evaluated Bidder (L1) would be arrived from the Grand Total above.

DECLARATION

- 1) I/We have read and understood the terms & conditions of the tender, accept it and comply to all Terms & Conditions of the Tender. There is no deviation in any part of the tender from my/our side. *(In case of any deviation the Bidder must attach a separate sheet clearly stating the clause no. of the Tender and deviation thereto)*
- 2) The undersigned is an authorized signatory and authorized to submit this bid and also certifies that the information provided by me/us in this bid is true and correct.
- 3) If the work is awarded, I/we assure that the entire work will be completed satisfactorily within the stipulated time as per the tender terms & conditions.
- 4) I/We agree to accept payment through Public Financial Management System (PFMS).

Name:

Signature of Authorised Signatory:

Date:

Place:

Seal:

***all pages of the price bid should be signed & stamped.**

TENDER SUBMISSION LETTER / OFFER FORWARDING LETTER

(To be submitted on the Bidder’s Letter Head)

Offer Reference No:.....

Date:.....

To,
Director,
National Centre For Polar & Ocean Research
Headland Sada, Vasco-Da-Gama,
Goa 403 804.

Dear Sir,

Sub : Submission of Offer against your Tender No:

I/We hereby offer to carry out the work detailed in your above Tender described as ‘**Construction of Satcom Facilities at NCPOR, Goa**’ in accordance with the terms and conditions thereof.

I/We have carefully perused the Tender documents connected with the above work and agree to abide by the same.

I/We hereby declare and confirm that I/we have visited the Work Site as referred in NCPOR Tender on (date)..... and acquired full knowledge and information about the Site conditions including geographical location, climate, wage structure, the office law & order and other conditions prevalent at and around the Site. We further confirm that we shall not raise any claim of any nature due to lack of knowledge of Site conditions.

I/We further agree to execute all the works referred to in the said Tender documents upon the terms and conditions contained or referred to therein and as detailed in the appendices annexed thereto.

I/We have submitted self declaration in lieu of EMD & will submit the requisite Earnest Money Deposit (EMD)/Bid security as per the tender terms.

I/We, hereby certify that all the information and data furnished by me with regard to the above Tender Specification are true and complete to the best of my knowledge. I have gone through the specifications, conditions, stipulations and all other pertinent issues till date, and agree to comply with the requirements and Intent of the specification.

I further certify that I am authorized to represent on behalf of my Company/Firm for the above mentioned tender and a valid Power of Attorney to this effect is also enclosed.

I/We, hereby certify that all the documents submitted by us in support of possession of “Qualifying Requirements” are copies of the original and are fully compliant required for qualifying / applying the bid and shall produce the original of same as and when required by NCPOR.

I / We hereby further confirm that no tampering is done with documents submitted in support of our qualification as bidder. I / We understand that at any stage (during bidding process or while executing the awarded works) if it is found that fake / false / forged bid qualifying / supporting documents / certificates were

submitted, it would lead to summarily rejection of our bid / termination of contract. NCPOR shall be at liberty to initiate other appropriate actions as per the terms of the Tender / Contract.

I/We hereby confirm that we have not changed/ modified/materially altered any of the tender documents as downloaded from the website/ issued by NCPOR and in case of such observance at any stage, it shall be treated as null and void.

We also hereby confirm that we have neither set any Terms and Conditions and nor have we taken any deviation from the Tender conditions together with other references applicable for the above referred Tender Specification.

I/We hereby confirm that my/our firm was never black listed from any office/institute/organization.

We confirm to have submitted offer in accordance with tender instructions and as per aforesaid references.

I/We hereby also declare that we will not share any details of our bid for this tender with any other person/company/firm & maintain confidentiality of document & information till the opening of bids.

Yours faithfully,

(Signature, date & seal of the Tenderer)

DECLARATION IN LIEU OF EMD/BID SECURITY**(To be submitted on the Bidder's Letter Head)**

I/We(Name and Address of the Bidder) am/are submitting this declaration in lieu of EMD/Bid Security for the Tender (Name of the Tender), (Tender No.....) and thereby fully accepting that I/We will be suspended and/or black listed and/or shall not be eligible to participate in any Tenders invited by National Centre for Polar and Ocean Research (NCPOR), for a period of Two years from the date of such Suspension, under the following circumstances:-

- a) If after opening of the Tender, I/We withdraw or modify my/our Tender bid during the period of bid validity as specified in the Tender Documents (including extended validity, if any)
- b) If do not accept any Tender Terms & Condition of the Tender Document.
- c) If after the award of work, I/We fail to furnish the required Earnest Money Deposit (EMD) or Bid Security as detailed in the Tender Document within the stipulated time.
- d) If I/We do not provide any information, documents as asked by you for the bid evaluation or contract finalization or contract execution purpose.
- e) If I/We fail to sign the Contract, within the stipulated time as mentioned in the Tender Document/Work Order
- f) If I/We fail or refuse to execute the contract as per the Terms & Conditions of the Tender Document.

Name & Signature of the Tenderer/Authorized Signatory with seal :

INSTRUCTIONS TO THE TENDERERS

Tenderers are advised to submit tender strictly as per conditions stipulated in the tender document. Please enclose the following with the tender & submit all in a **Single Sealed Cover**.

Cover (Sealed):

1. Tender Submission Letter (Annex – VIII) from the Tenderer **on his firm's letterhead**.
2. Documents of Eligibility Criteria as mentioned in Annexure – I
3. Declaration in lieu of EMD/Bid Security (Annexure – IX)
4. Particulars of the Tenderer with the documents mentioned to enclose therein (Annexure - IV)
5. Work Completion Proforma (Annexure – V) along with self attested copies of Work Orders & Work Completion Certificates.
6. Price Bid (Annexure – VII, with signature & stamp on all pages)

All above document should be submitted in one sealed envelope (SINGLE BID SYSTEM) superscribing **Name of the Tender, Tender Number, date and time of tender opening** and address to **Director, National Centre for Polar & Ocean Research, Headland Sada, Vasco-Da-Gama, Goa**. Tender duly completed in all respect should be dropped in the tender box kept in the office of Estate section well before the due date & time.

Tender Opening : Tender will be opened on the scheduled date & time. An authorized representative of the bidding firm/company can only attend the bid opening (only one person is allowed). Owner/Proprietor/Director of the bidding firm should provide his/her visiting card, copy of photo ID proof. Bidder's representative should submit authorization letter, copy of photo ID to the Tender Opening Committee. Persons attending bid opening must use face masks, maintain social distancing, use sanitizer/wash hands & strictly follow guidelines of MoHFW, Govt. of India for COVID pandemic situation.

--sd--

Estate In-Charge

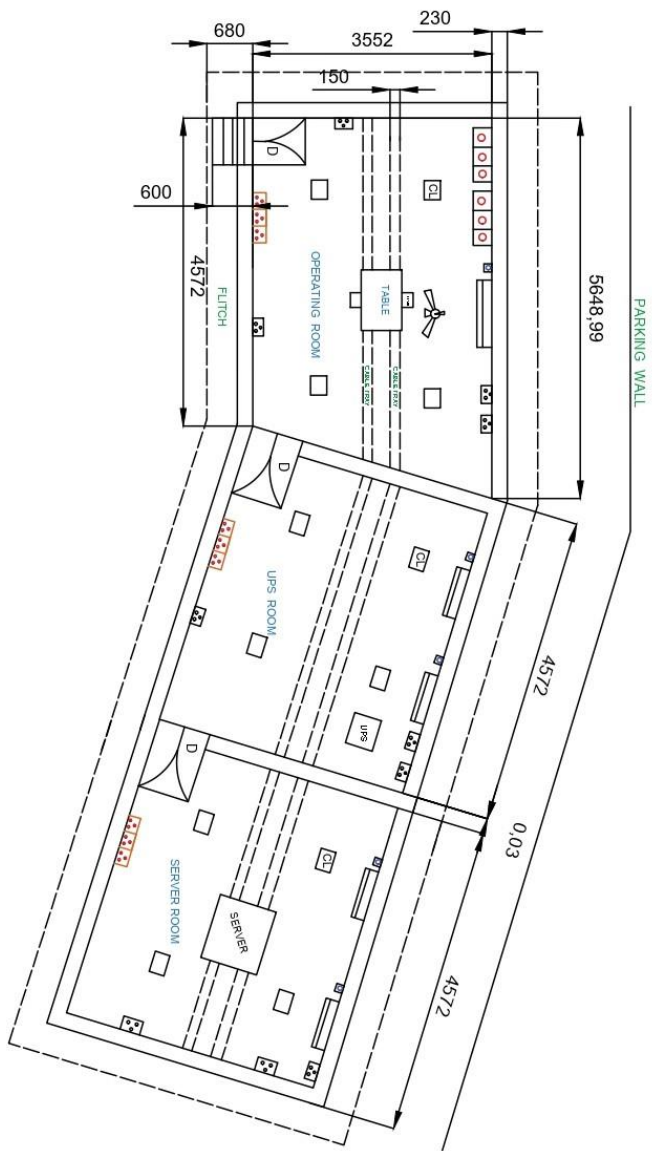

LEGEND	
SYMBOL	DESCRIPTION
	16A POWER SOCKET
	8 MODULE SWITCH BOARD
	2'x2' FEET FALL CEILING LIGHT
	42 MODULE MAIN DISTRIBUTION BOARD
	1.5 TON AC (6.5kW)
	FULCH
	CABLE TRAY
	DOOR (W: 1 meter, H: 2.1 meter)
	CEILING FAN
	ROOM HEIGHT - 3048 mm
	8 WAY MODULAR UPS DISTRIBUTION BOARD